

Fast and easy maintenance- the Inogen benefit.

Inogen Rove 4™ Column Change Guide

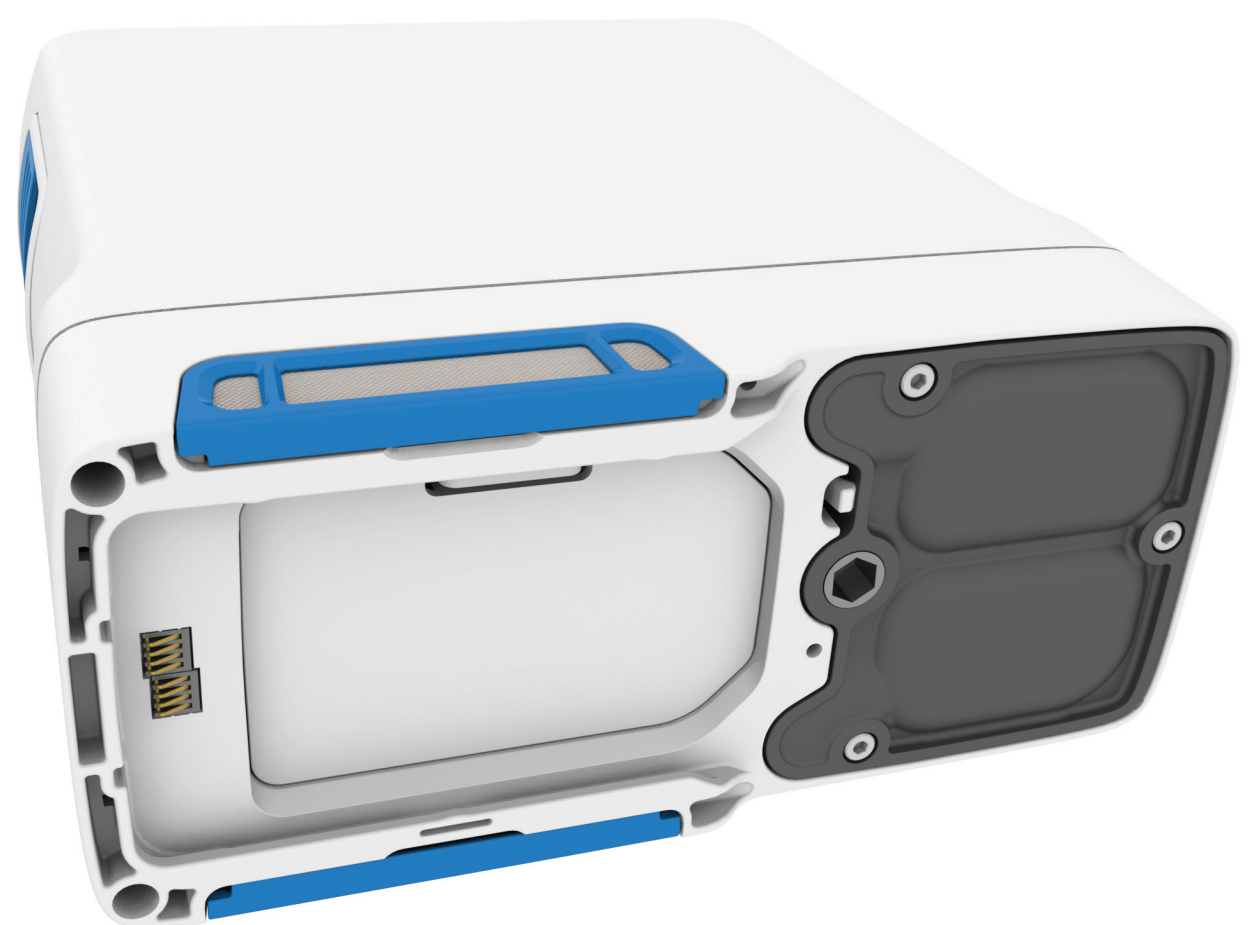

Your Equipment Provider:

Your Physician:



859 Ward Drive, Suite 200
Goleta, CA 93111, USA
1-877-4-INOGEN (Toll Free)
1-877-446-6436 (Toll Free)
1-805-562-0515 (International)
info@inogen.net
www.inogen.com

96-11647-00-01 B



Inogen Rove 4™

To change the columns on your Inogen IO-401, first:

- 1 Turn off the device by pressing and holding the power button. 
- 2 If using, remove the device from the carry case.



NOTE Column change instructions are only to be used when maintenance is required and are not intended for practice purpose.

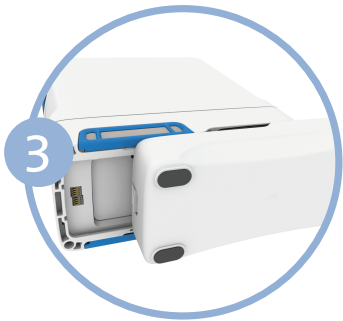

Remove the battery from the device.

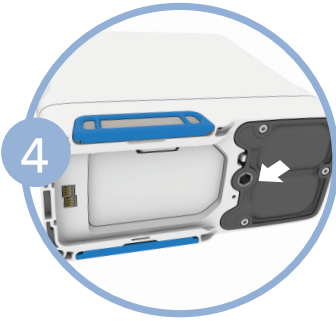

Place the device on its side so that the underside is visible. The columns are on one side of the device.

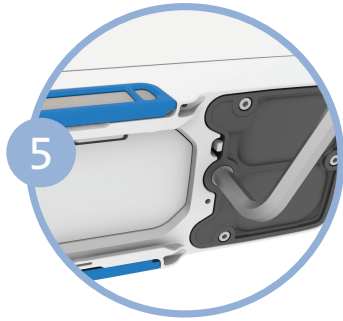

Unlock the columns by inserting the hex key into the socket and turning counterclockwise until they are released.

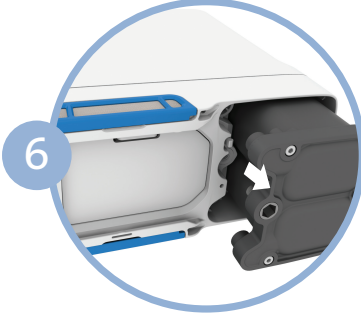

Remove the columns completely from the device by pulling outward. Both columns are removed as one piece.

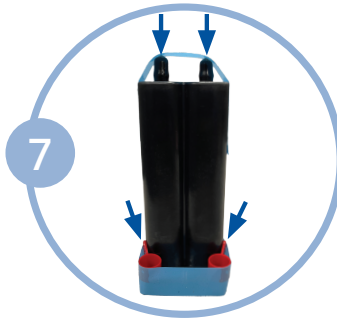

If tape is applied to column assembly, remove tape. To install new columns, first remove the four (4) dust caps from the new columns. Make sure there is no dust or debris where the dust caps were located.

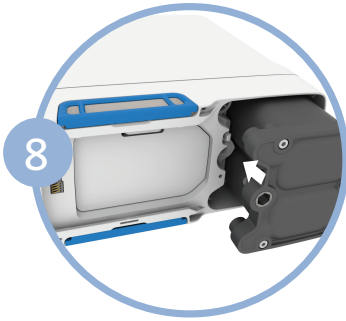

Insert the new columns into the device immediately after removing the dust caps. DO NOT leave the column ends exposed. Push the columns into the device as far as possible.

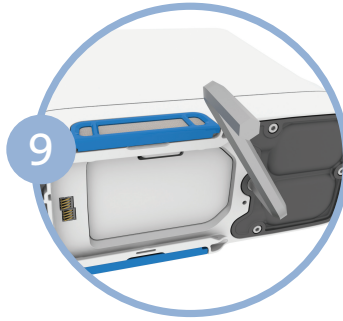



Insert the hex key into the socket. Turn clockwise until columns lock into place. Do not overtighten. **IMPORTANT:** You need to notify the device that you have replaced the columns. This can be done through the device itself or through the Inogen Connect App.

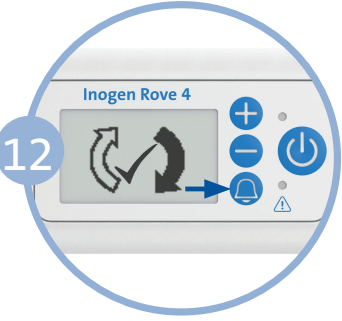

RESETTING THE COLUMNS THROUGH THE DEVICE
Connect the device to AC power but DO NOT power on the device.



Press the bell  button once. The screen will display the 'sieve reset success' informational icon. Press and hold the power  button to turn on the device.

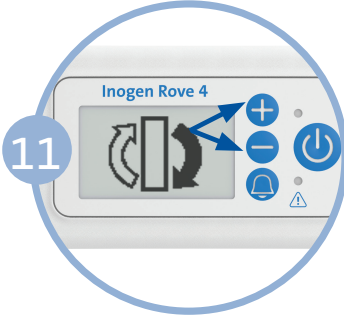

Press and hold the plus (+) and (-) minus button for 5 seconds. The screen will display the 'sieve reset' informational icon. Release the buttons once the 'sieve reset' icon is displayed on screen.